

Maintenance

- Check daily :
- Weekly :
Monthly :
- Yearly :
- Note :
- Emergency-, safety devices and general operation of the door.
 - Presence of loose parts, sharp edges or broken glass.
 - Safety and contrasting stickers are applied.
 - Lighting; to provide a proper level of illumination inside the door.
 - Floor condition; avoid slipping or tripping hazards and excessive dirt inside the door.
 - Clean the anodised, powder coated and/or stainless steel surfaces with a wet cloth.
 - Clean the anodised, powder coated and/or stainless steel surfaces with a wet cloth and a non-aggressive soap. Stainless steel surfaces need to be cleaned according the instruction below, Vacuum clean all the brushes.
 - The door needs a major maintenance check once a year. This has to be done by Boon Edam or an approved agent. This applies as well for repairs.
 - Make sure maintenance is properly recorded in the Logbook inside the door.

Caution !



Don't use water near the drive-units or control boxes.

Warning !



Switch OFF the power supply of the door during maintenance or other work.

Cleaning Instruction

- Sensors :
- Stainless steel parts:
- Remove dirt and dust with a wet cloth and dry with a clean soft cloth. Avoid scratching!!
 - Use sponge to wipe the parts clean and dry with a clean cloth.
 - Apply an even spray Inno-x on the surface to be treated or spray it on a clean, dry and soft cloth and apply. Rub off with a clean, dry and soft cloth.

Operating limitation



Do not use the door when the wind force at the entrance exceeds the Beaufort value as indicated in the table below. To prevent damage or injuries make sure the door is switched off and locked.

Diameter [meter]	
3,6	10
4,2	9
4,8	9
5,4	8
6,0	8
7,4	8

Instruction Card

Tournex

Safety- and operating instructions

Control panel

Status Indicator

Locking devices

Maintenance

Cleaning Instruction

Operating limitation

Explanation of the symbols

Outside

Inside

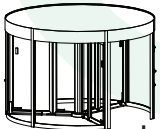





Door set rotates on normal speed.



Door set stops.



Door set rotates on slow speed.



Door set rotates into restposition.



Door set does not rotate.



Door set rotates manually.



No power supply.



Emergency push button.



Disabled stop button.



Emergency open button.



Doorset blocked.



Optional / CE Plus.



Extra country specific.

Caution :



- Any children or minors using the product must be supervised by a responsible adult.
- This product should not be considered as a playground. Do not let children play inside or near the door.
- Push doorwing for emergency open position (optional collapsible doorset).
- Running or dashing into a closing door are prohibited.
- In case of broken glass do not use the door. Take all necessary precautions to avoid people coming into contact with sharp edges of the broken glass.

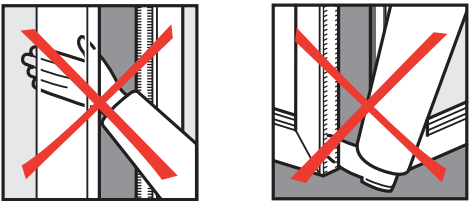

Safety- and operating instructions

A. The Tournex safety devices

1 Safety Rail Bent wall (SRB).

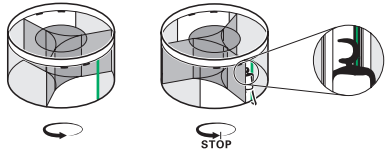

2 Safety Rail Doorwing (SRD).

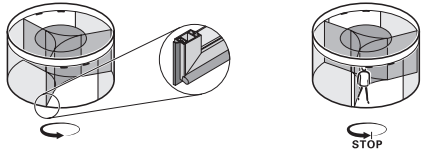

3 Safety Rail Turning wall passive (SRT).

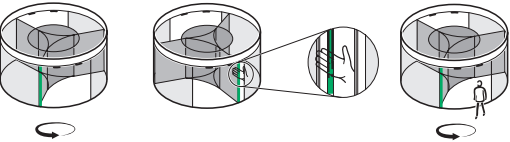

4 End Buffer Sensor (EBS).

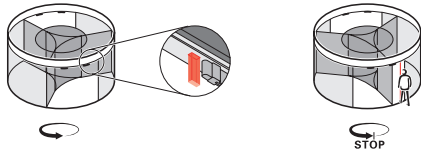

5 Top Rail Sensor (TRS).

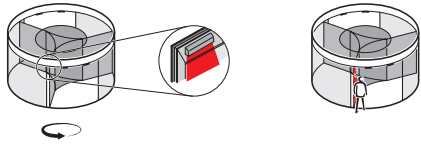

6 Top Rail Sensor Extension (TRS)*

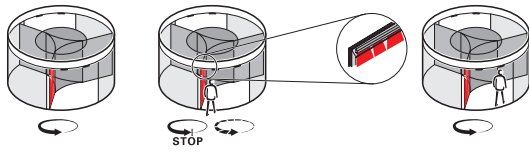

7 Block detection

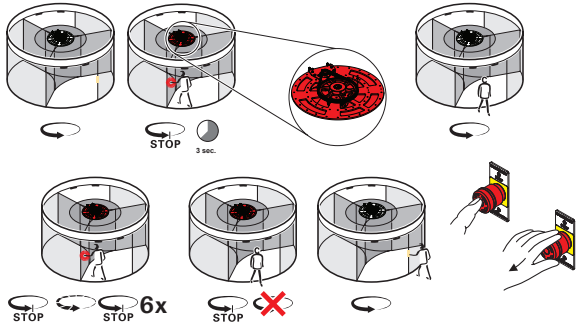

8 Emergency push button inside (outside*)

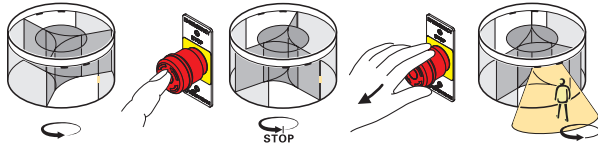

9 Disabled push button*



10 Failsafe

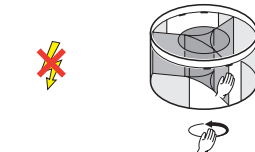

11 Collapsible door set*(Emergency escape position)

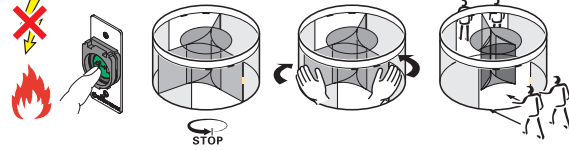

12 Safety Rail Turning wall active (SRT)**

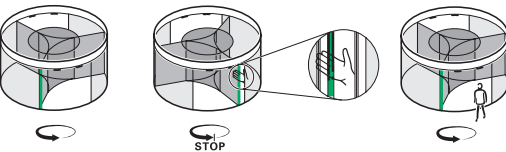

13 Extra Throatopening Sensor (ETS)**.

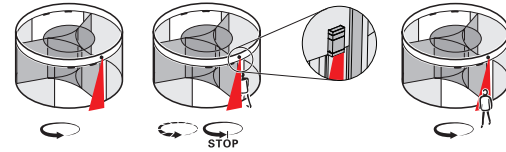

B. The working principles of the Tournex.

1 Off / Night mode.

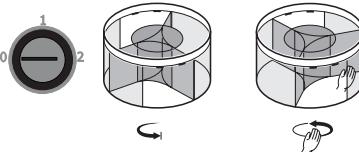

2 Day mode

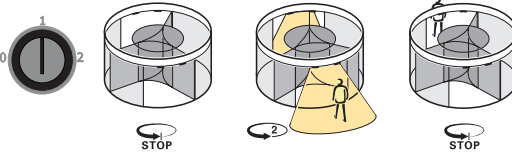

3 Door set blocked mode.

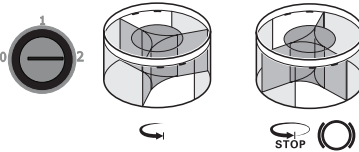

4 Continuously slow (idle speed).

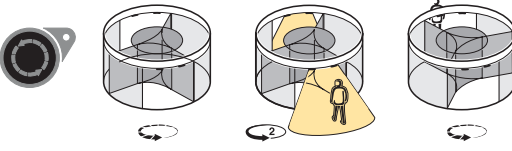

Controle panel

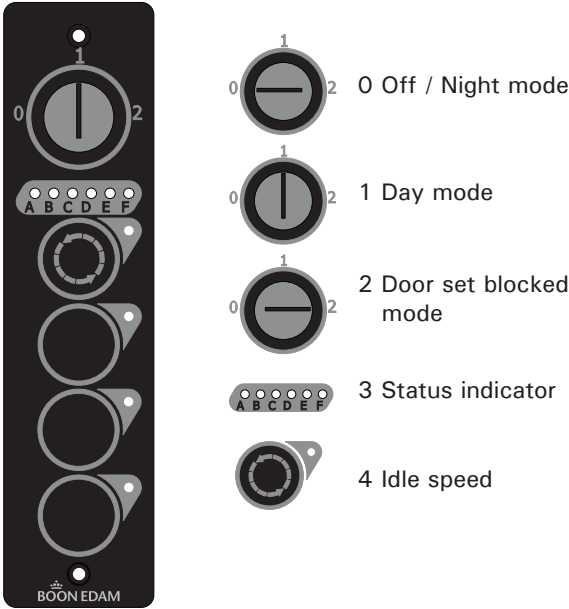

Locking devices

A. Doorwings

1 Doorwing & -positioning units.

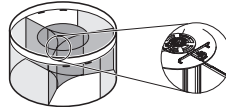

B. Door set blocked mode

1a Intergrated electronmagnetic lock.

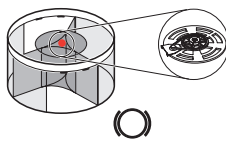

1b Fail-safe

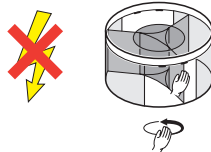

C. Off / Night mode

1 Espagnolet lock*

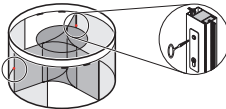

2 Night sliding doors*

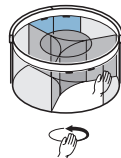

Status Indicator

Code	Description of activations and failures
32	Emergency stop Active
26	Top Rail Sensor active
23	Fire alarm active
21	Block detection active
16	Safety Rail Bent wall Active
15	Safety Rail Door wing Active
10	Motion Sensor Failure
7	Door collapsed
5	Door Locked
4	End Buffer Safety Active